

# Section 2

# Drains

# General Purpose Drains

## Maxxflow™ Available in 17 Styles & Sizes DRAINS

- Low profile head affords excellent drainage
- Ideal for both scuppers and deck drains
- Fits marine sanitation hose
- All models available with stoppers



4056 - Long Thread with Crosshairs



4057 - Long Thread with Crosshairs



4116 - Short Thread with Crosshairs



4130 - Long Thread with Anti-Slosh Valve



4134 - Short Thread with Anti-Slosh Valve



4201



4202



4203



4058 - Straight Drain



4136 - "T" Drain with Anti-Slosh Valve

Part NO.	Description
<b>3/4" STRAIGHT DRAINS</b>	
4004	No Stopper (Black w/ white head)
<b>1" STRAIGHT DRAINS</b>	
4058	(Black w/ white head)
<b>1 1/2" STRAIGHT DRAINS</b>	
4112	(Black w/ white head)
4112C	(Black w/ chrome head)
<b>1 1/2" "T" DRAINS</b>	
4136	w/Anti-Slosh Valve (Black w/ white head)
<b>STOPPERS</b>	
4201	Small Drain Stopper (Black)
4202	Medium Drain Stopper (Black)
4203	Long Drain Stopper (Black)

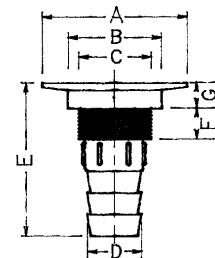
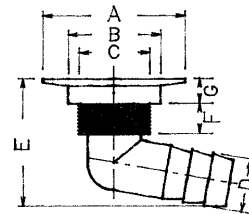

100° elbow lessens the chance of clogging.

Part NO.	Description
<b>5/8" ELBOW DRAINS</b>	
3998C	5/8" Elbow Drain w/ Stainless Steel Screen
3998	5/8" Elbow Drain w/ White Plastic Screen
<b>3/4" ELBOW DRAINS</b>	
4006	3/4" Elbow Drain w/ Stainless Steel Screen
<b>1" ELBOW DRAINS</b>	
4056	1" Elbow Drain w/ Stainless Steel Screen
4057	1" Elbow Drain w/ White Plastic Screen
4059	1" Elbow Drain w/ White Plastic Screen
<b>1 1/2" ELBOW DRAIN</b>	
4111	Long Thread w/ Crosshairs (black w/ white head)
4111C	Long Thread w/ Crosshairs (black w/ chrome head)
4116	Short Thread (black w/ white head)
4116C	Short Thread (black w/ chrome head)
4117	Long Thread (black w/ white head)
4117C	Long Thread (black w/ chrome head)
4130	Long Thread w/ Anti-Slosh Valve (black w/ white head)
4134	Short Thread w/ Anti-Slosh Valve (black w/ white head)

Part NO.	Dimensions						
	A	B	C	D	E	F	G
3998	2.075	1.375	0.850	0.625	2.600	1.175	0.325
4006	—	—	1.025	0.750	2.450	1.025	—
4056	2.100	1.400	1.325	1.000	3.000	1.200	0.375
4057	—	—	—	—	3.000	1.200	—
4058	—	—	—	—	2.875	0.475	—
4059	—	—	—	—	2.550	0.475	—
4111	2.850	2.000	1.900	1.500	3.750	1.550	0.550
4111C	2.900	—	—	—	—	—	—
4112	2.850	2.000	1.900	1.500	3.575	0.650	0.550
	2.900	—	—	—	3.575	0.650	—
4116	2.850	—	—	—	2.800	0.600	—
4116C	2.900	—	—	—	2.800	0.600	—
4117	2.850	2.000	1.900	1.500	3.750	1.550	0.550
4117C	2.900	—	—	—	3.750	1.550	—

Made, Assembled, & Packaged in the U.S.A.

All Barb Measurements Reflect Inner Hose Diameter